

THREE SETS OF PLANS REQUIRED WITH THE FOLLOWING INFORMATION:

- Project address, owner and contractor information.
- Description detailing work that will take place.
- Plot plan indicating where deck will be located in relation to house and property lines, include all existing structures and setbacks.
- Provide details showing: size, material, and spacing of framing.
- Show size and type of decking material.
- Show height above the adjacent finished grade.
- Show locations, size and depth of footing for piers. (INSPECTION REQUIRED PRIOR TO POURING CONCRETE)
- A handrail is required for stairs with four or more risers, mounted at 34 to 38 inches in height from nosing of step, with a return at each end.
- Stairs shall be a minimum of 36 inches wide. Maximum rise of each step is 7-3/4 inches, the minimum run is 10 inches. The largest width or height of any step shall not exceed the smallest by more than 3/8 inch.
- Guardrails are required for decks over 30 inches in height, and must be at least 42 inches high, intermediate rail spacing or pattern to be so that a 4-inch sphere cannot pass through.
- Show method of attachment of deck to building: ledger, flashing, size and spacing of fasteners.
- Indicate that work will comply with current building codes.
- Provide a total valuation of construction project cost.

Wood shall be pressure treated or of natural resistance to decay. New pressure treatment methods use chemicals that will prematurely corrode standard fasteners, hardware and flashing in contact with treated lumber. All anchors and fasteners must be hot-dipped galvanized or stainless steel. All deck hardware must be galvanized with 1.85 zinc coating. All post to beam attachments are required to have positive connections in order to resist uplift and lateral displacement, typically this is done with metal straps and clips.

DECK – EXAMPLE OF DETAILS:

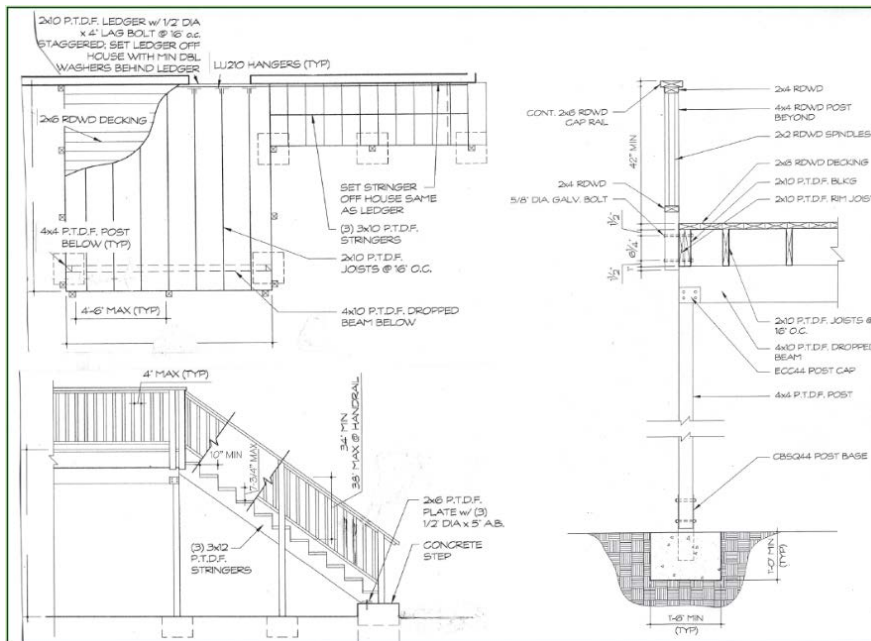

August 2017