

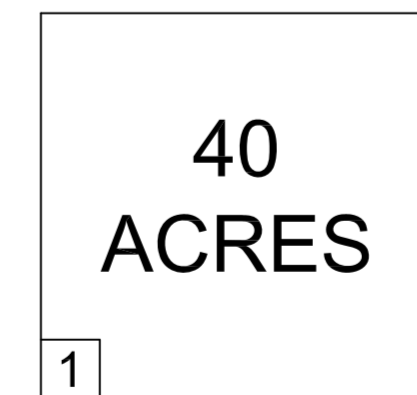

CITY OF REEDLEY GENERAL PLAN LAND USE MAP

(AS ADOPTED BY CITY COUNCIL RESOLUTION No. 2014-018, DATED FEBRUARY 25, 2014)

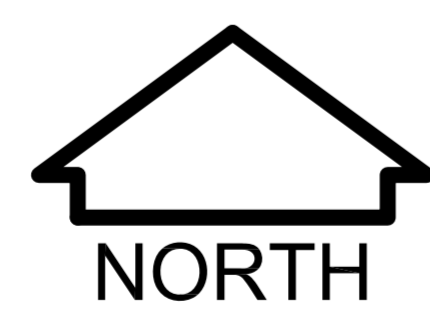
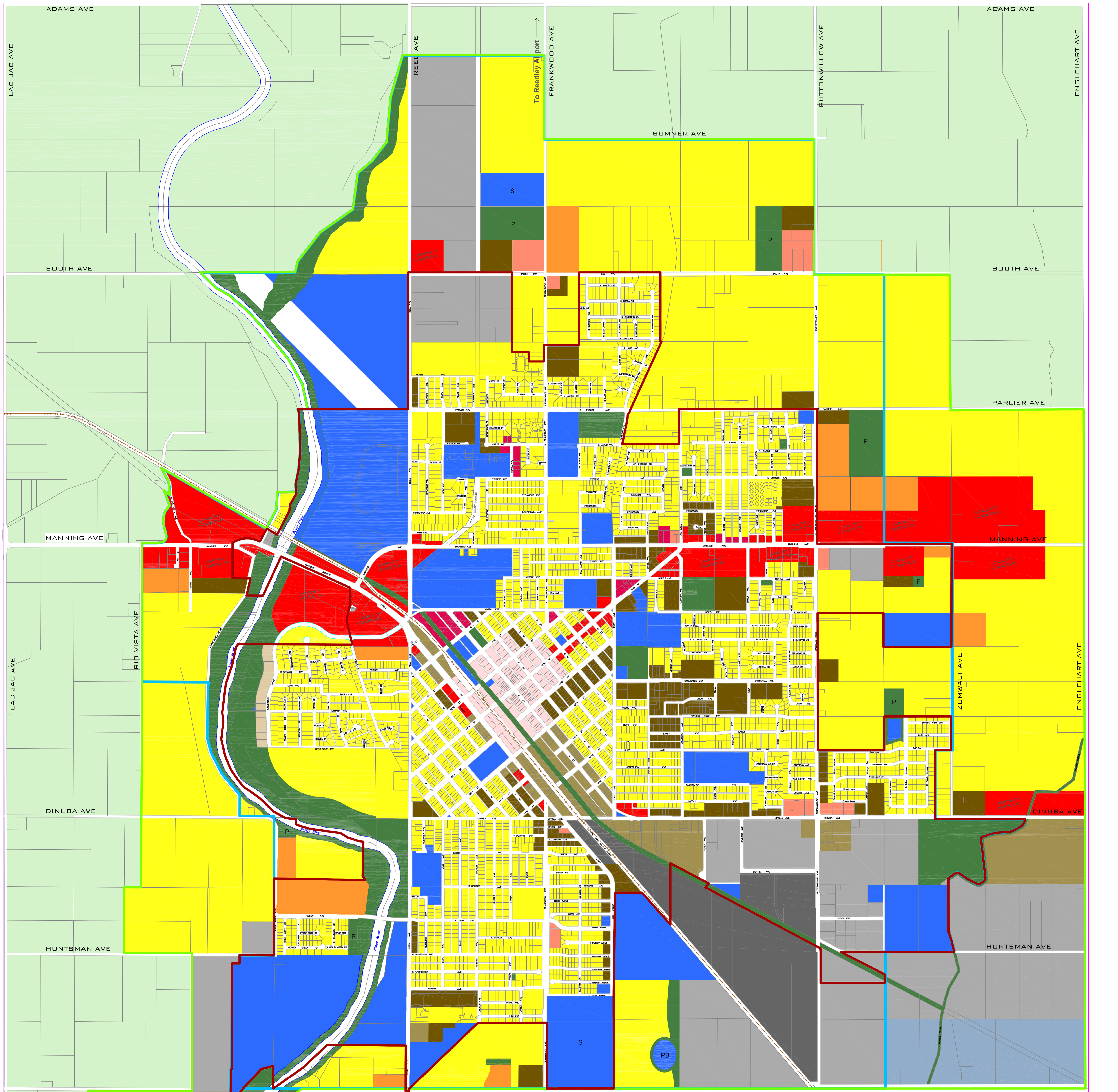

RESIDENTIAL

- SUBURBAN (1-4 DU/ACRE)
- LOW (4-8 DU/ACRE)
- MEDIUM (8-15 DU/ACRE)
- HIGH (15-29 DU/ACRE)

OTHER

- OPEN SPACE
- PUBLIC / INSTITUTIONAL FACILITY
- REMAINDER OF STUDY AREA
- COMMUNITY BUFFER

COMMERCIAL

- CENTRAL DOWNTOWN
- NEIGHBORHOOD COMMERCIAL
- COMMUNITY COMMERCIAL
- OFFICE
- SERVICE COMMERCIAL

INDUSTRIAL

- LIGHT INDUSTRIAL
- HEAVY INDUSTRIAL

BORDERS

- EXISTING CITY LIMITS (3,433 ACRES TOTAL)
- LAFCO SPHERE OF INFLUENCE (5,053 ACRES TOTAL)
- APPROVED SPHERE OF INFLUENCE (7,087 ACRES TOTAL)
- GEN PLAN STUDY AREA (10,620 ACRES TOTAL)

MISC

- P PROPOSED FACILITY / PARK
- S PROPOSED SCHOOL
- PB PROPOSED PONDING BASIN

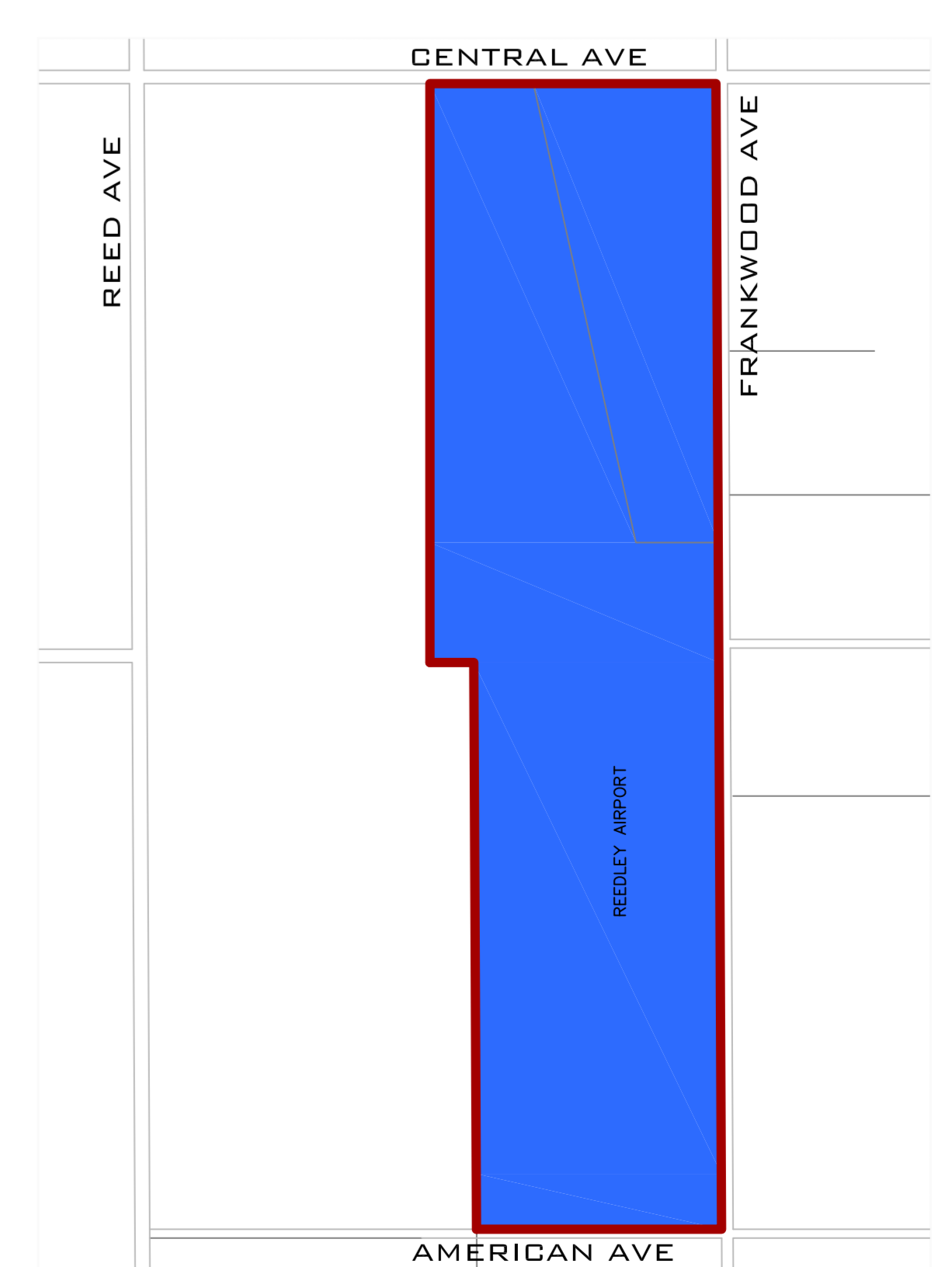

Reedley Airport: Approximately 15,400 Ft. (2.9 Miles) North from the intersection of Frankwood and South Avenue's.